

Once the mounting base is installed, attach the alarm by twisting clockwise until it clicks. If the battery is either missing or inserted incorrectly, or the switch is in 'Learn Mode', the heat alarm will not be able to click into the mounting base.

CLICK THE HEAT ALARM FIRMLY INTO THE BASE TO LOCK

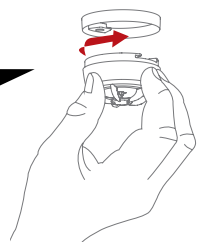

6. TEST FUNCTION:

After installation, and at least once per quarter, test all of your alarms to ensure they are operating correctly and are within range of each other.

It is recommended to check visually every week if the LED flashes correctly (every 48sec.)

Press the test button on any alarm for 2 sweeps of alarm signal 1 (--- --- ---) - Please refer to section 8. This will send out a test signal from the alarm; all other connected alarms should receive the signal within a short time. The alarms will emit a short beep and the LED will flash every 8 seconds for 2 minutes.

NOTE: Test function also allows to send a depleted RF signal to ensure an optimal operation in normal conditions.

When the test signal is sent out, the alarms will respond in two ways:

1. A single beep every 8 seconds indicates that the alarms are connected and functioning.
2. Three short beeps every 8 seconds indicates a heat sensor fault.

If required this indication can be stopped early on each alarm by a short press of the test button.

If the problem continues, please visit www.cavius.com for any trouble shooting.

7. NORMAL MODE:

In normal mode the LED will flash every 48 seconds to show correct operation.

8. ALARM MODE:

When a rapid and constant change of temperature is detected, the heat alarm will go into 'Alarm Mode'. It will sound the alarm signal and the LED will flash.

The heat alarm will also transmit the alarm signal to the other connected alarms, which will also sound the alarm signal after a short delay.

The CAVIUS Wireless Family have two different alarm signals:

Alarm signal 1 (--- --- ---) is life threatening alarms, like a smoke alarm.

Alarm signal 2 (- - -) is a non life threatening alarm, like a flooding alarm:

Smoke alarm signal: --- --- ---
 Heat alarm signal: --- --- ---
 Flood alarm signal: - - -
 CO alarm low level signal: - - -
 CO alarm high level signal: --- --- ---

Please note that only the originating alarm's LED will flash, so it can be identified.

9. PAUSE/HUSH FUNCTION:

If the heat alarms are to set into a false alarm by cooking, fireplace, etc. they can be paused for 10 minutes by pressing the test button on the originating heat alarm only (indicated by the flashing LED).

The reason of this is that it is necessary to locate the source of the alarm before using the hush function. This is to make sure that it is not a life threatening situation.

10. ADD EXTRA DEVICE:

WIRELESS ALARM FAMILY

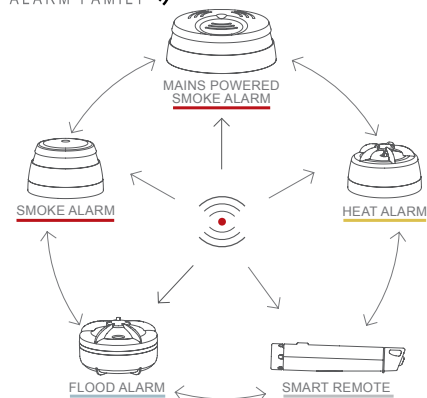

All CAVIUS interconnected alarms within the

WIRELESS ALARM FAMILY can be added to the system as they run on the same frequency and use the same data protocol. This means that the wireless system can consist of a combination of smoke, heat, flood etc.

Place all alarms into 'Learn Mode' and repeat section 1.

Always test connection to all devices by repeating test function section 6 after adding devices.

11. LOW BATTERY SIGNAL:

Your product has a 5Y battery life. When the battery is starting its end of life, a short beep will sound out every 48 seconds for 30 days.

The alarm effected by the low battery will only beep, no other connected alarms will sound.

It is safe to change batteries in the alarms without going through the learn process again – they will not forget the codes during the battery change process.

12. BATTERY REPLACEMENT:

To replace the battery, detach the heat alarm from the mounting base by twisting counterclockwise. Replace the battery respecting the polarities.

Attach the alarm in the mounting base by twisting clockwise until it clicks, and test the alarm.

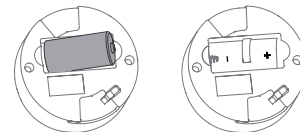

13. TROUBLE SHOOTING:

If you are experiencing false alarms with just general cooking, you may have your heat alarm too close to the cooking hobs and stove. Try reinstalling slightly further away to alleviate any issues.

If the heat alarm does not work when the test button is pushed, the probable cause is a faulty battery. Check if the battery is worn out and replace it. **Always test the alarm after replacement of battery.**

If the problem continues, please visit www.cavius.com for any trouble shooting.

14. OTHER INFORMATION:

Do not paint the alarm.

Disposal: For battery and product, please dispose properly at the end of life. This is electronic waste which should be recycled.

Note the local country regulations regarding installation.

The CE mark affixed to this product confirms its compliance with the European Directives which apply to the product.

Tested to comply to the standard of system heat alarms EN54-5 class A1/R.

Alarm condition aural signal pattern according to ISO 8201.



All Rights reserved: Cavius Aps assumes no responsibility for any errors, which may appear in this manual. Furthermore, Cavius Aps reserves the right to alter the hardware, software, and/or specifications detailed herein at any time without notice, and Cavius Aps does not make any commitment to update the information contained herein. All the trademarks listed herein are owned by their respective owners. Copyright © Cavius Aps.

Developed by CAVIUS Aps Julsøvej 16, DK-8600
 Manufactured in P.R.C.